

## Description

Automotive LED bulb is an LED bulb best suited for automotive applications. They consume low current this helps conserve battery power while preventing dimming of other lights on the vehicle when turned on. They have a built in optic to emit light in all directions. These LED Bulbs are long lasting and turn on instantaneously. As they don't contain any glass and filaments, they are immune to mechanical shocks and vibrations. These bulbs are available in Ba15, Ba9 and Ba7 holder in all colors and all voltages.



## The STANESH edge

- Instant Turn-on
- Low power consumption
- Exceptional long life, rigid and vibration resistant
- Dual brightness level also available for brake lights
- Specially designed optic for wide illumination and side illumination
- Available in all colors and voltages
- Available in Ba15 , Ba9 and Ba7 holder



## Available Types

Part No.	Colour	Voltage
LED bulb Ba15s	Red, Amber (Orange), Yellow, Green, Blue & White	12VDC (other voltage and AC/DC available on request )
LED Bulb Ba15d		
LED Bulb Bay15D (Brake light)		
LED Bulb Ba9S		
LED Bulb Ba7s		

## Electrical Specifications

Symbol	Description	Typical	Unit
$V_{dc}$	DC Input operating voltage	12.0	V
$V_{peak}$	DC Input surge voltage (10sec max)	15.0	V
$I_{nom}$	DC Input current (+-10%) Ba15 type Ba9 & Ba7 type	0.06	A
		0.02	A
$P_{in}$	Power Ba15 type Ba9 & Ba7 type	0.8	W
		0.3	W
$t_a$	Ambient Temperature	40	°C
$t_c$	Rated maximum temperature	70	°C

## Mechanical Specifications

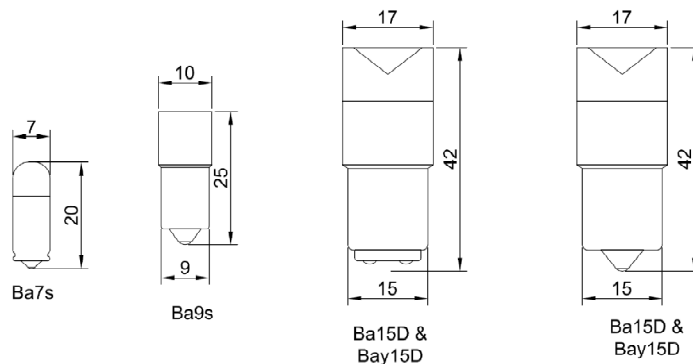

(All dimensions are in mm)